

DM838W Network Music Player with Amplifier



Features

- 5.0" TFT touch screen;
- Bluetooth, MP3, SD card and AUX input, network audio source;
- Support App, Airplay and DLNA;
- Timer function for music playing and turn on/off;
- Built-in 2x20W power amplifier, built-in DSP effect;
- Built-in Hi-Fi digital amplifier, 2.1 outputs support active subwoofer;
- RJ45 (TCP/IP network) interface for connecting to intelligent control and integrated with smart home devices;
- RJ45 network interface connect to LAN or wireless router; can be controlled by APP;
- Infrared remote control;
- Support picture and video displaying;
- Quad-core processor, 1G running RAM, 8G integrated storage, support SD card up to 32G;
- Based on android platform, support online software update

1. Installation Steps

① Install cassette and wiring

Amplifier Output, Antenna

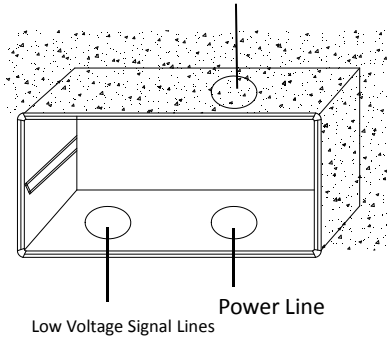

Cassette in-wall installation

Cassette size: (L×W×H) 172×86×55mm

② Turn off power supply (Push the switch to right)

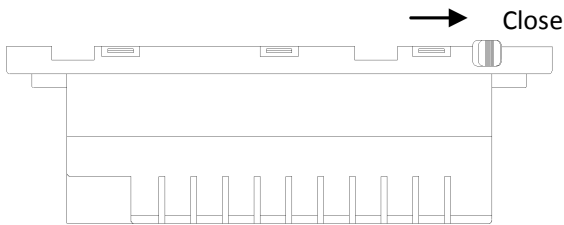

③ Connect to wiring terminal

④ Use screws to fix bottom box to Cassette

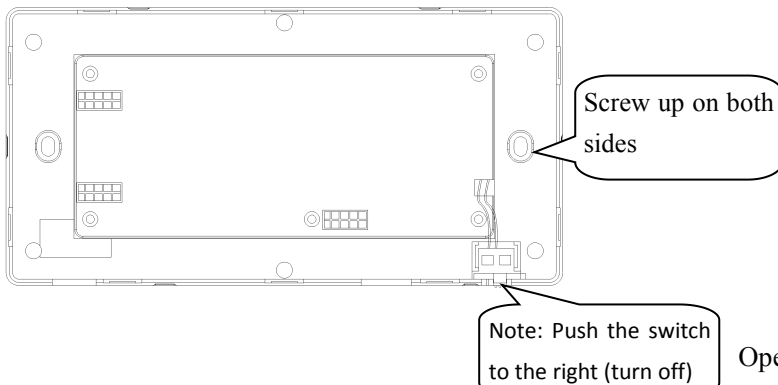

⑤ Install the button battery in panel

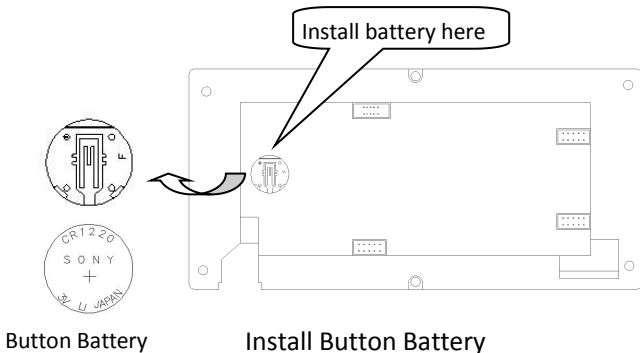

⑥ Half install panel and test

Half install panel to the bottom box → Turn on power (Push the switch to left) → Functional test

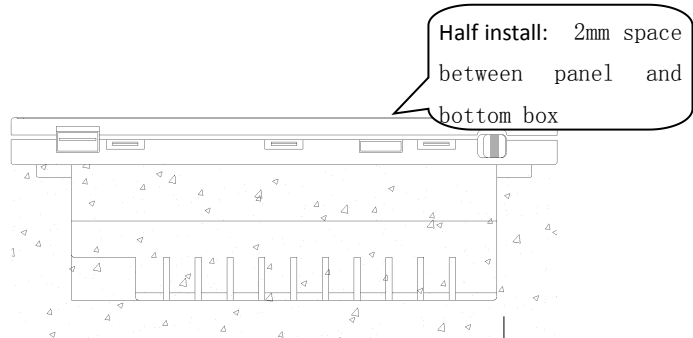

⑦ Fastening the panel after test is ok and

Installation is complete

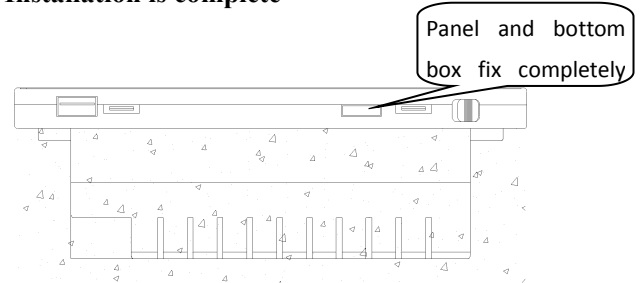

2. Dismounting

① Turn off the power

② Open the fix buttons →

Pull out the panel horizontally

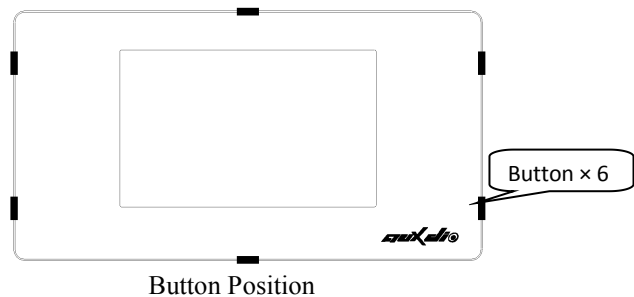

Open the middle button with thumb or other objects (not sharp) slide from upper left corner gap to right, open the rest buttons by slide along the gap. You will hear a sound like 'Click' when each button is opened.

1. Pull out the panel horizontally after open all the buttons.

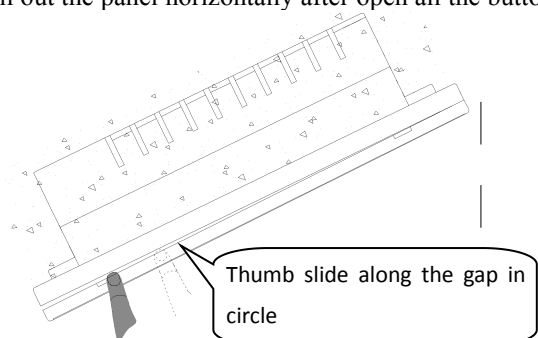

3. Wiring Diagram

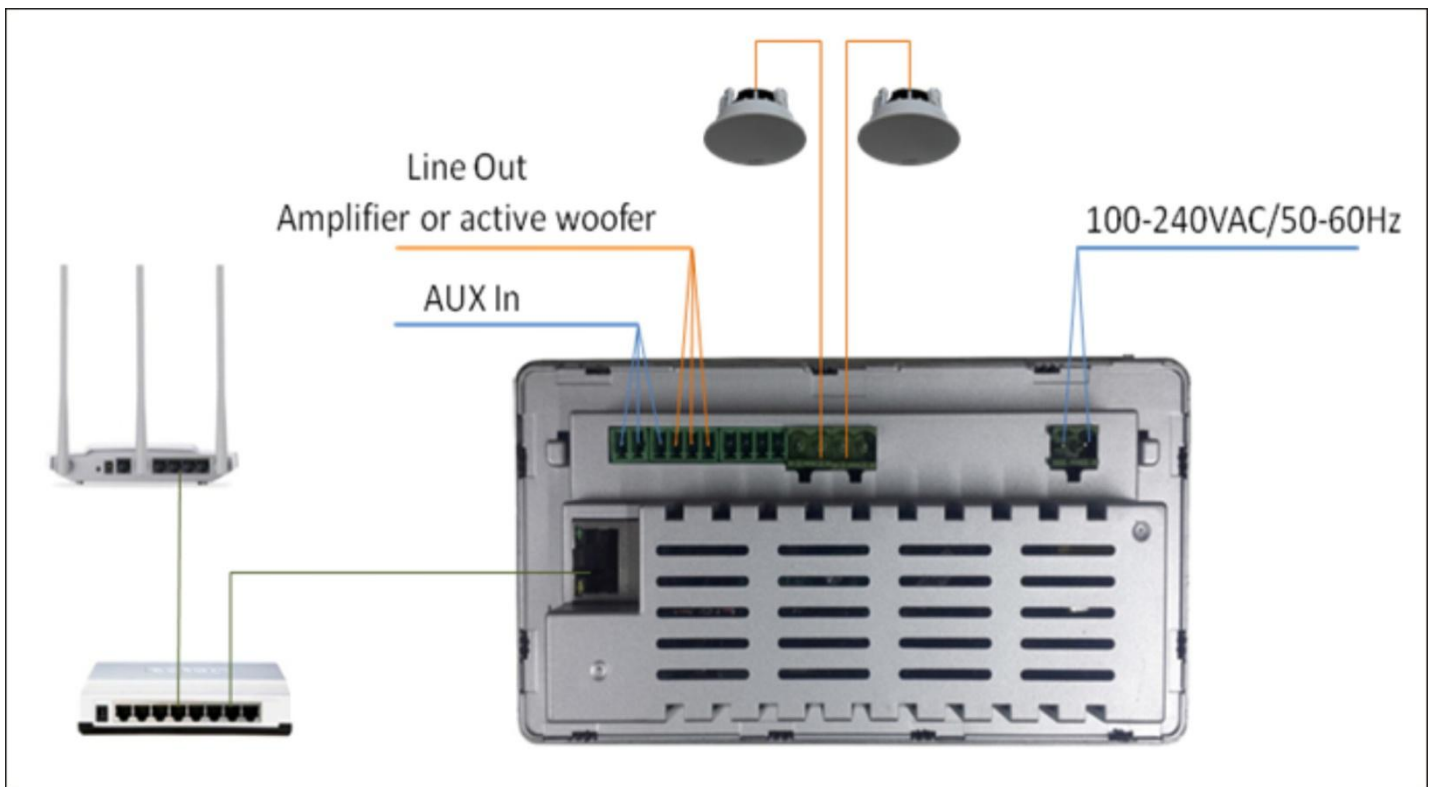

4. Connection & Control

